



Vaccine Module (VaxTrax)

May 19, 2021

2700 Patriot Blvd, Suite 250 | Glenview, IL 60026 | 561-413-4697 | <https://www.kokomo247.com>

Mobile App Instructions

1. Download Our Mobile App



- a. iOS <https://apps.apple.com/us/app/ims-enterprise/id1504839321>
- b. Android <https://play.google.com/store/apps/details?id=com.kokomo247.ims.enterprise>

2. Login to the mobile app

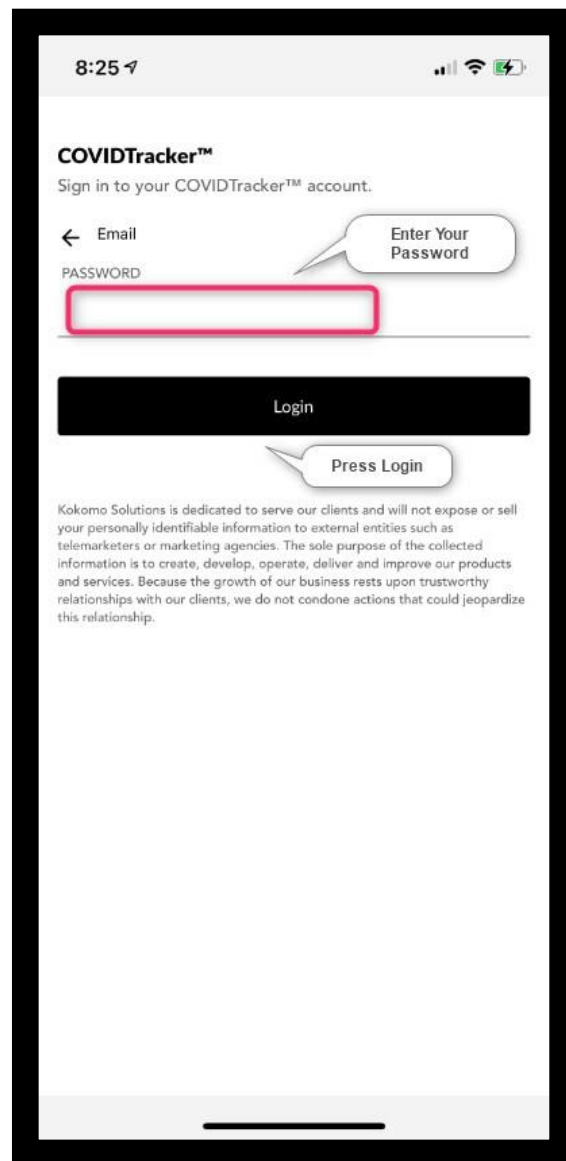
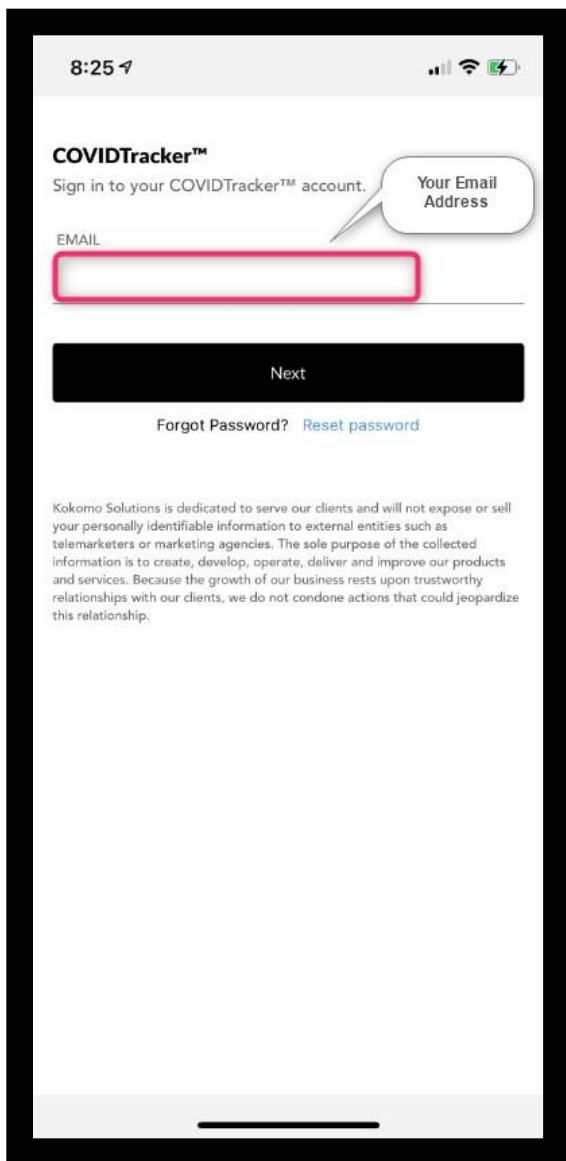

3. Click on the + button on the top right corner of the section

This will take you to a new page where the users can enter their information



- To submit the vaccine details, click on Vaccination card.

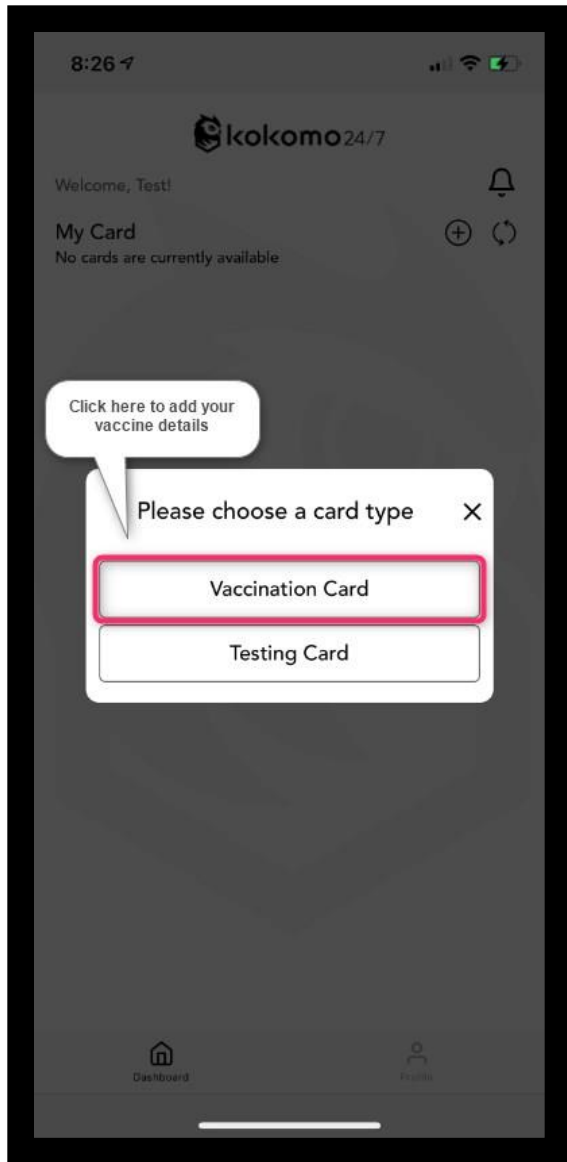

4. For Vaccination Card, users must provide the below details
 - a. Type of Vaccine
 - b. Total Shots required
 - c. Dosage Information
 - d. Attach a photo of the vaccine card

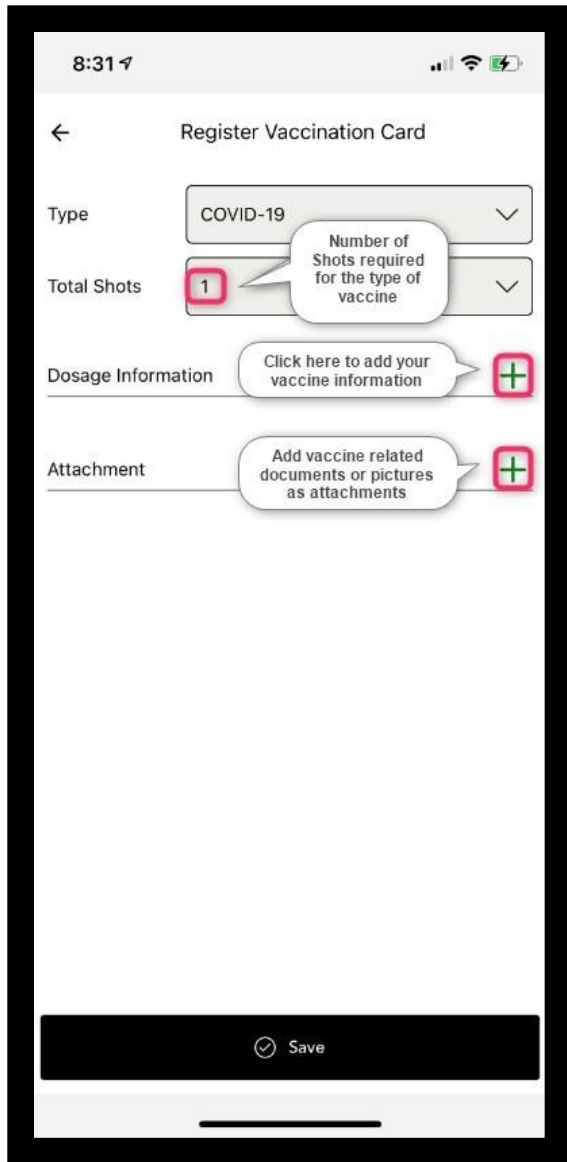

5. For dosage information, users can provide the below details
 - e. Provider Name (optional)
 - f. Lot Number (optional)
 - g. Hospital ID (optional)
 - h. Date of Vaccination (required)

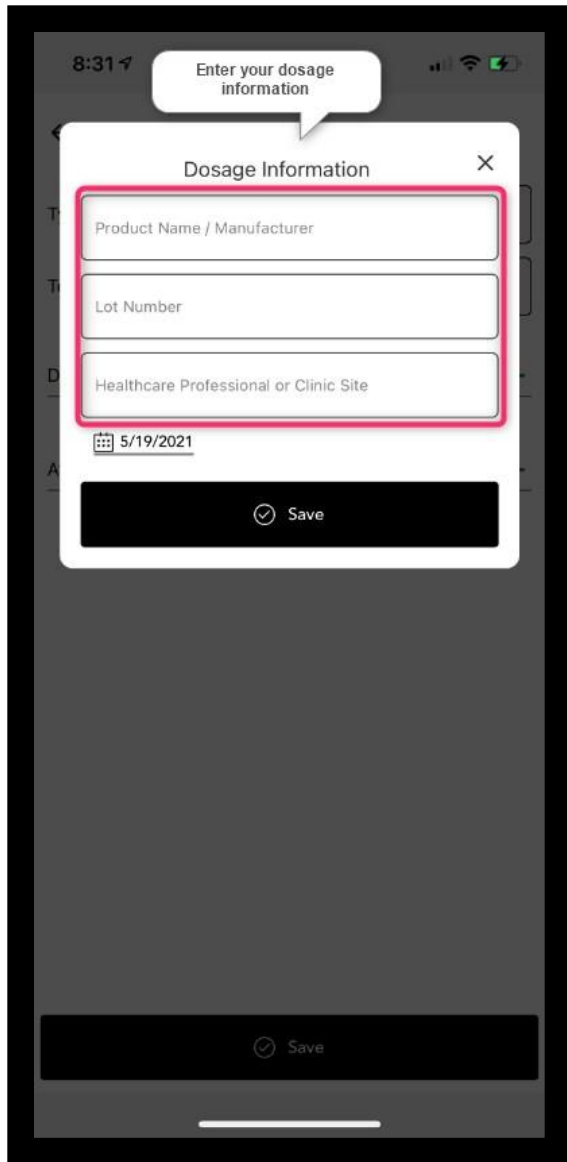

Note: There are 2 ways to add the dose information,

- a) If the person has taken both doses of the vaccine, they can add both right away while creating the first vaccine card.
 - b) If the person has taken only one dose of the vaccine, they can edit the existing card and add the second dose information to it.
- To submit the test results, click on testing card.

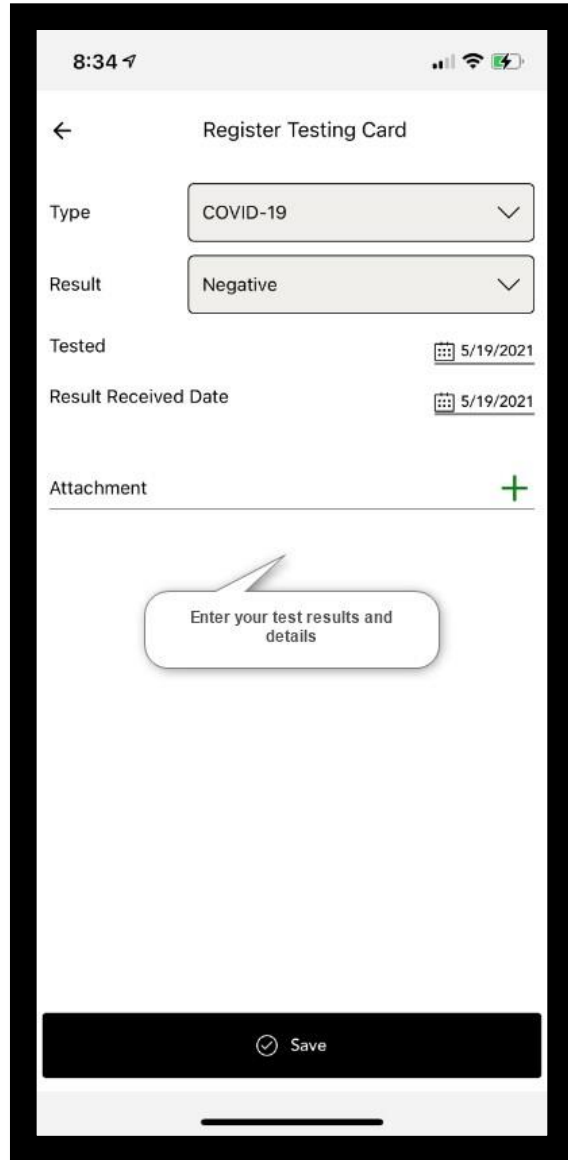
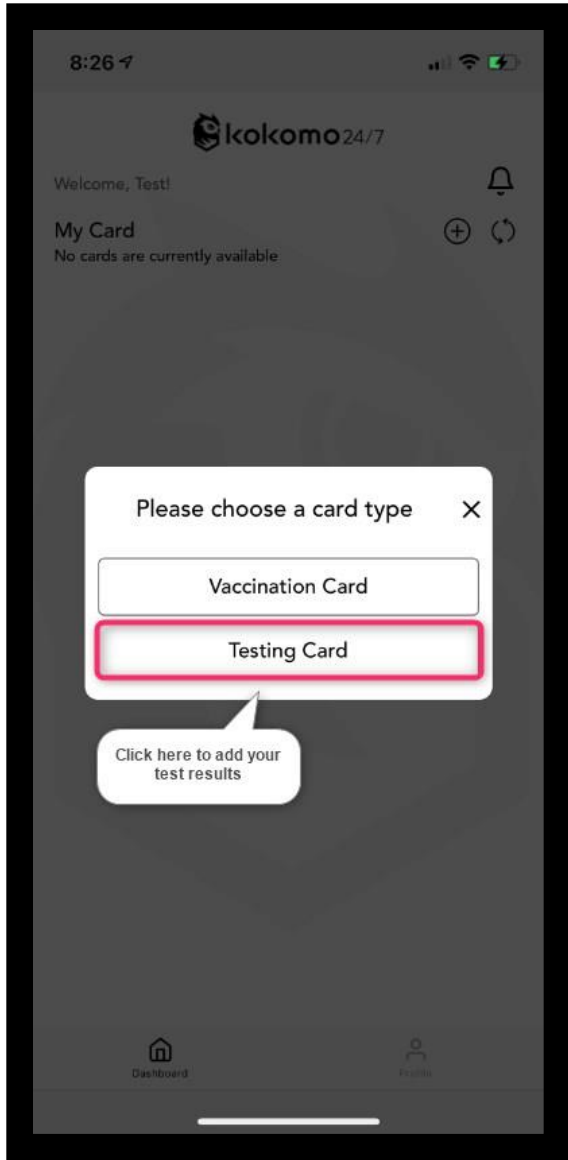

You will start seeing the Vaccination Card and Testing Card under My Card section.



Note: If you are submitting the forms on behalf of someone else (dependent) Please select the name from the drop-down menu and submit the information.

